



LET'S BUILD A BETTER FUTURE

 FRONT ENTRY DOORS / **AP** series



PANELLED DOOR

// EXCELLENT THERMAL INSULATION

# ECO-HOME with VitrineAlu

Front entry doors; aren't they one of the most important parts of our home? They protect us from the cold, the rain, and the burglars, to mention just a few examples. Doors also keeps us away from street noise. But how do you make the right choice, and buy a door that will meet our expectations and serve us for years?

An issue that requires careful consideration before the purchase is the heat transfer coefficient (U). The lower its value, the more heat will stay with us inside. Aluprof offers **panelled doors with the  $U_D$  coefficient of 0.50 W/(m²K).**

When choosing our door, let's not forget to check out their water resistance. It's the water resistance of the door that will keep the driving rain outside in times of strong winds and heavy rain. The higher the class, the better the door protects our home. **Aluprof offers panelled doors rated E1200 (1200 Pa).**

Infill panels are included in door leaves based on the MB-86 system, and come in a variety of colours and structures. The elements can be milled, decorated with applications or made of insulated glass. **Panelled doors can be fabricated very large and high – up to 1.40 m (W) and almost 2.60 m (H).** If, therefore, we dream of an impressive front entrance, this will be the perfect choice. But above all, the door should fit to the style of your home. If our interiors are the traditional ones, we should opt for a leaf with glass panels or wooden-like veneer. Lovers of modern interior can choose among RAL colours, think shade of graphite.

Let's take some time and choose a door with which we will create a beautiful entrance that will enchant our guests and will make us feel like we were in a safe haven.

## MB-104 Passive

$U_D$  from 0.50 W/m²K

The structure of panel doors is based on the popular thermally broken aluminium sections MB-104 Passive, which is the most technologically advanced VitrineAlu system to date. The leaf profile is designed for coupling with special infill panels that can be installed flush with the door frame plane. This system is dedicated to energy-efficient and passive buildings.

Aesthetically pleasing, decorative panels are available in many variants, RAL and woodgrain colours

Construction variants: SI, SI+ & AERO

Central gaskets around the leaf and the frame are to seal, cover, and increase the thermal insulation performance of the door



Expansion joint profiles

95 mm wide doorsill – frame and doorsill are equally wide

### Technical details:

Frame depth	95 mm
Leaf depth	95 mm
Infill panel thickness	up to 95 mm
Maximum dimensions of the leaf	(HxL) L up to 1400 mm, H up to 2600 mm

### Technical parameters:

Air permeability	Class 3, PN-EN 12207:2001
Water tightness	Class E1200 (1200 Pa), PN-EN 12208:2001
Wind load resistance	Class C4/B4, PN-EN 12210:2001
Thermal insulation	$U_D$ from 0.50 W/m²K



MB-86

U<sub>D</sub> from 0.66 W/m²K

The structure of panel doors is based on the thermally-broken aluminium sections MB-86, which, similarly to MB-104 Passive is dedicated to energy-efficient and passive buildings. The leaf profile is designed for coupling with special infill panels that can be installed flush with the door frame plane.

Aesthetically pleasing, decorative panels are available in various designs and colours

They come in four versions: ST, SI, SI + and AERO for a very good thermal performance

Weather strips provide high water tightness and air permeability, bringing comfort and money savings



Technical details:

Frame depth	77 mm
Leaf depth	77 mm
Infill panel thickness	44 and 77 mm
Maximum dimensions of the leaf	(H x L) L up to 1400 mm, H up to 2600 mm

Technical parameters:

Air permeability	Class 3, PN-EN 12207:2001
Water tightness	Class E900 (900 Pa), PN-EN 12208:2001
Wind load resistance	Class C5/B5, PN-EN 12210:2001
Thermal insulation	U <sub>D</sub> from 0.66 W/m²K

Rigid and durable aluminium profiles allow to fabricate of large-dimensioned doors

The selected seals ensure high water- and air tightness and air, improving the comfort of use and reducing the cost.

MB-70

U<sub>D</sub> from 0.9 W/m²K

The structure of panel doors is based on the popular thermally-broken aluminium sections MB-70 oraz MB-70HI which complete the range of energy-efficient doors in the VitrineAlu port-folio. Similarly to other panel door system the leaf profile is designed for coupling with special infill panels that can be installed flush with the door frame plane.

Elegant decorative panels, available in may different patterns and RAL colours and wood effect finishes

Expansion profiles and door leaf panels

Two variants of structure: MB-70 oraz MB-70HI, which enable obtaining very good thermal performance



Technical details:

Frame depth	70 mm
Leaf depth	70 mm
Infill panel thickness	44 and 70 mm
Maximum dimensions of the leaf	(H x L) L up to 1200 mm, H up to 2400 mm

Technical parameters:

Air permeability	Class 4, PN-EN 12207:2001
Water tightness	Class 7A (300 Pa), PN-EN 12208:2001
Wind load resistance	Class C5/B5, PN-EN 12210:2001
Thermal insulation	U <sub>D</sub> from 0.9 W/m²K

Polyurethane rigid foam (PUR) with excellent thermal insulation performance.

The selected seals ensure high water- and air tightness and air, improving the comfort of use and reducing the cost.



## BASIC



### Insert panels

- Triple glazing units  
 $U_g$  0.5 W/m<sup>2</sup>K or  $U_g$  0.7 W/m<sup>2</sup>K
- Panel thickness from 44 to 72 mm
- U-value for MB-70HI door  $U_D$  from 1.1 W/m<sup>2</sup>K, for MB-86 door  $U_D$  from 0.9 W/m<sup>2</sup>K and for MB-104 door  $U_D$  from 0.61 W/m<sup>2</sup>K
- Four construction variants: ST, SI, SI+ & Aero

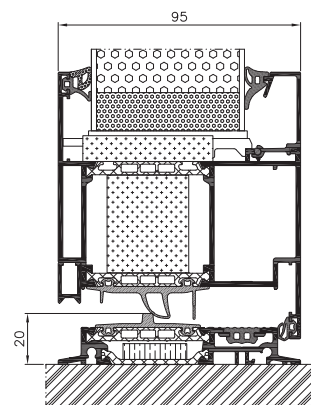

## CLASSIC



### Flushed on one side

- Triple glazing units  
 $U_g$  0.5 W/m<sup>2</sup>K or  $U_g$  0.7 W/m<sup>2</sup>K
- Panel thicknesses from 44 to 85 mm
- U-value for MB-70HI door  $U_D$  from 1.0 W/m<sup>2</sup>K, for MB-86 door  $U_D$  from 0.9 W/m<sup>2</sup>K and for MB-104 door  $U_D$  from 0.53 W/m<sup>2</sup>K
- Four construction variants: ST, SI, SI+ & Aero

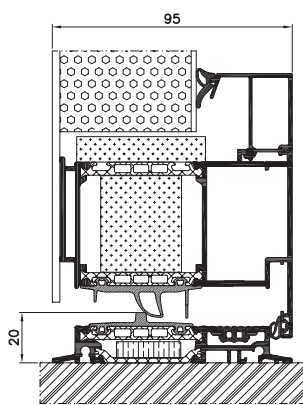

## EXCLUSIVE



### Flushed on both sides

- Triple glazing units  $U_g$  0.5 W/m<sup>2</sup>K or  $U_g$  0.7 W/m<sup>2</sup>K
- 77 mm thick panel (MB-86) and 95 mm (MB-104 Passive)
- U-value for MB-70HI door  $U_D$  from 0.9 W/m<sup>2</sup>K, for MB-86 door  $U_D$  from 0.66 W/m<sup>2</sup>K and for MB-104 door  $U_D$  from 0.50 W/m<sup>2</sup>K
- Four construction variants: ST, SI, SI+ & Aero

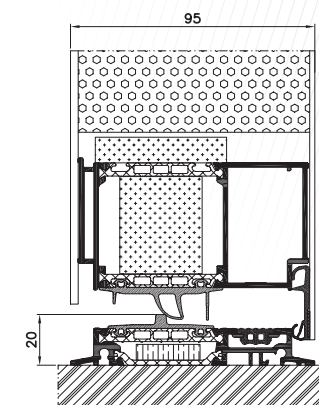

All available models can be inserted into the profiles or glued on one or both sides.







AP21  
p. 10

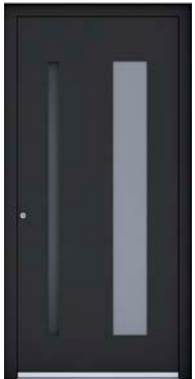

AP22  
p. 10



AP23  
p. 11



AP24  
p. 11



AP25  
p. 12



AP16  
p. 16



AP18  
p. 16

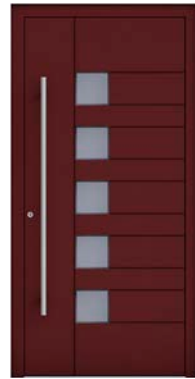

AP07  
p. 17



AP03  
str. 17



AP08  
p. 17



AP26  
p. 12



AP27  
p. 13



AP28  
p. 13



AP11  
p. 13



AP29  
p. 14



AP13  
p. 18



AP09  
p. 18

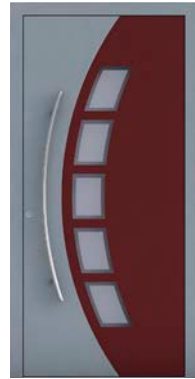

AP12  
p. 19



AP15  
p. 19



AP17  
p. 19



AP30  
p. 14



AP19  
p. 14



AP01  
p. 15



AP02  
p. 15

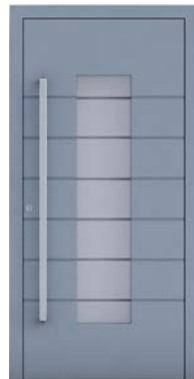

AP31  
p. 16



AP05  
p. 20



AP04  
p. 20



AP10  
p. 20



AP20  
p. 21



AP21 with a sidelite

- APZ 1600 flush pull handle\* Flush inlay
- Alunox 5 mm; on the outside face
- Surface finish: RAL 9005



AP22

- APZ 1600 flush pull handle\*
- Glass pane:
  - outer: VSG 33.1
  - middle: Satinato
  - inner: insulating glass with low-E coating
- Surface finish: RAL 7021

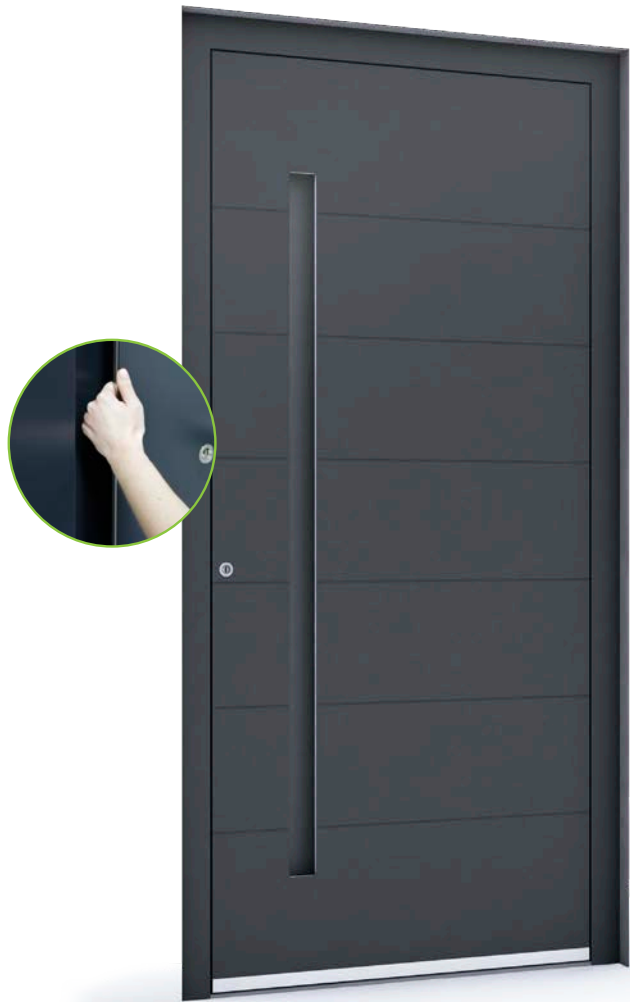

AP23

- APZ 1600 flush pull handle\*
- 5 mm carves; on the outside face
- AP 3021 kickplate
- Surface finish: DB 703



AP24 with a sidelite

- APZ 1600 flush pull handle\*
- AP 3021 kickplate
- AP 3500 anti-scratch protection
- Surface finish RAL 9016

\* Models with APZ flush pull handle are available for panel thickness range of 65-95mm

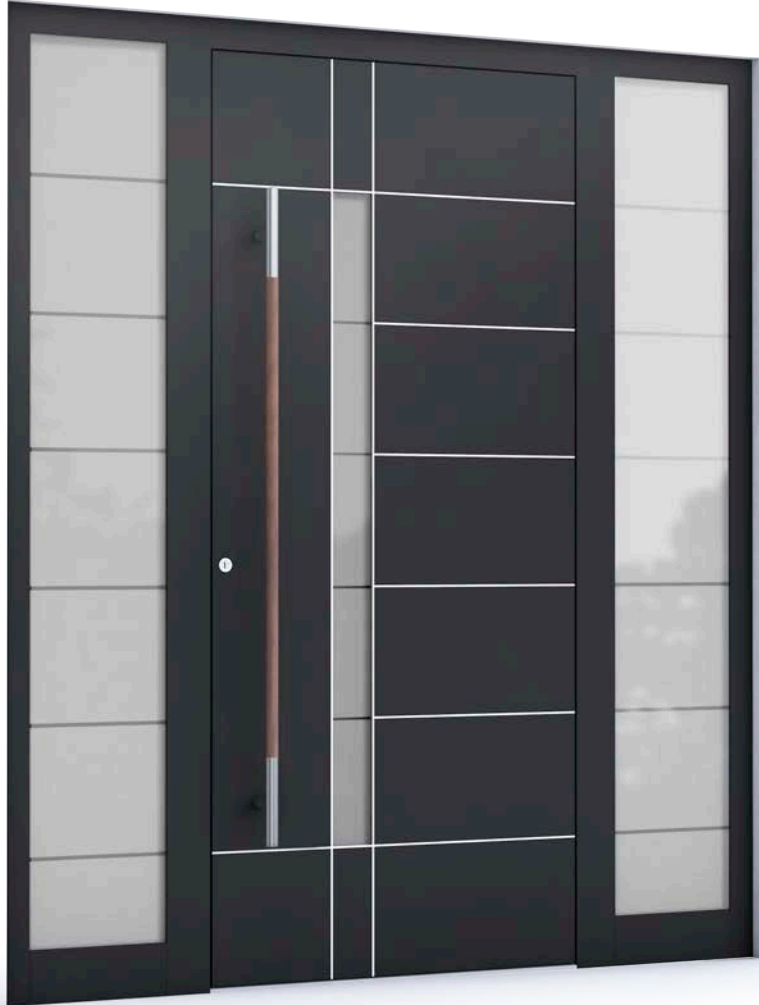

AP25 with a sidelite

- AP 200.1400 door pull handle made of high-grade steel/Jatobe wood
- 5 mm flush Alunox inlay; on the outside face
- Glass pane:
  - outer: VSG 33.1
  - middle: sandblasted glass, chosen motif
  - inner: insulating glass with low-E coating
- Surface finish: RAL 9005



AP26

- AP 40.1600 door pull handle made of high-grade steel
- 5 mm flush Alunox inlay; on the outside face
- Glass pane:
  - outer: VSG 33.1
  - middle: Satinato
  - inner: insulating glass with low-E coating
- AP 3400 anti-scratch protection
- Surface finish: RAL 3004



AP27

- AP 60.1600 door pull handle made of high-grade steel
- 5mm carves; on the outside face
- Glass pane:
  - outer: VSG 33.1
  - middle: Satinato
  - inner: insulating glass with low-E coating
- Surface finish: RAL 7016



AP28

- AP 60.1600 door pull handle made of high-grade steel
- 5 mm Alunox inlay; on the outside face
- Glass pane:
  - outer: VSG 33.1
  - middle: Satinato
  - inner: insulating glass with low-E coating
- Surface finish: RAL 9016



AP11

- AP 80.1625 door pull handle made of high-grade steel
- 5 mm Alunox inlay; on the outside face
- Glass pane:
  - outer: VSG 33.1
  - middle: sandblasted with transparent frame
  - inner: insulating glass with low-E coating
- Surface finish: RAL 9007

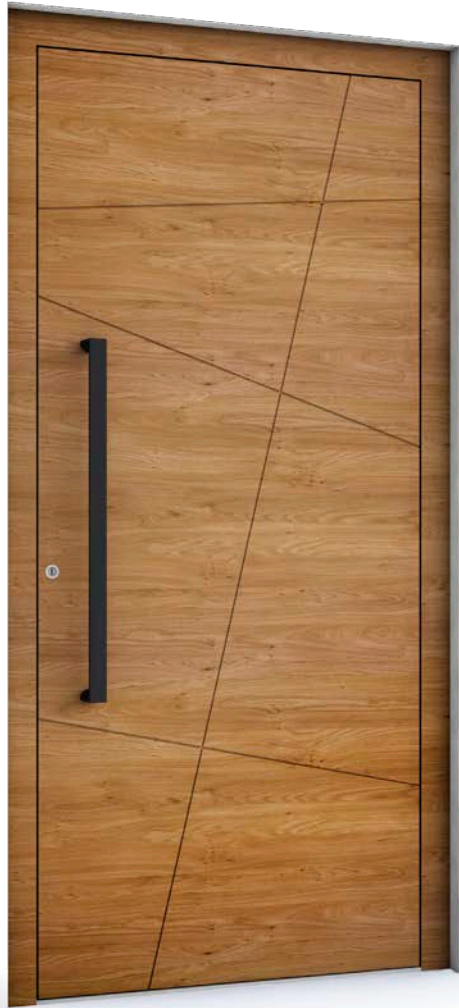

**AP29**

- AP 46.825 door pull handle made of high-grade steel, finished in black
- U-type carves; on the outside face
- Surface finish: Winchester - ADEC D207



**AP30**

- AP 130.1030 door pull handle made of high-grade steel
- 5 mm flush Alunox inlay; on the outside face
- Surface finish: RAL 7016



**AP19**

- AP 60.800 door pull handle made of high-grade steel
- Glass pane:
  - outer: VSG 33.1
  - middle: sandblasted with transparent strips
  - inner: insulating glass with low-E coating
- Surface finish: RAL 9016



**AP01**

- AP 40.1600 door pull handle made of high-grade steel
- Flush Alunox inlay; on the outside face
- Glass pane:
  - outer: VSG 33.1
  - middle: sandblasted with transparent strips
  - inner: insulating glass with low-E coating
- AP 3021 kickplate
- AP 3400 anti-scratch protection
- Surface finish: RAL 9005



**AP02** *with a sidelite*

- AP 60.1600 door pull handle made of high-grade steel
- Flush Alunox inlay; on the outside face
- Glass pane:
  - outer: VSG 33.1
  - middle: sandblasted with transparent strips
  - inner: insulating glass with low-E coating
- AP 3400 anti-scratch protection
- Surface finish: RAL 7016





- AP31**
- AP 46.1625 door pull handle made of high-grade steel
  - Carves; on the outside face
  - Glass pane:
    - outer: VSG 33.1
    - middle: sandblasted with transparent strips
    - inner: insulating glass with low-E coating
  - Surface finish: RAL 7001



- AP16**
- AP 60.1600 door pull handle made of high-grade steel
  - Carves; on the outside face
  - Glass pane:
    - outer: VSG 33.1
    - middle: sandblasted with transparent strips
    - inner: insulating glass with low-E coating
  - Surface finish: RAL 9016



- AP18**
- AP 80.1625 door pull handle made of high-grade steel
  - Carves; on the outside face
  - Flush Alunox inlay; on the outside face
  - Glass pane:
    - outer: VSG 33.1
    - middle: sandblasted with transparent strips
    - inner: insulating glass with low-E coating
  - AP 3021 kickplate
  - Surface finish: RAL 7015



- AP07**
- AP 40.1600 door pull handle made of high-grade steel
  - Carves; on the outside face
  - Glass pane:
    - outer: VSG 33.1
    - middle: sandblasted with transparent frame
    - inner: insulating glass with low-E coating
  - Surface finish: RAL 3004



- AP03**
- AP 60.1600 door pull handle made of high-grade steel
  - Flush Alunox inlay; on the outside face
  - Glass pane:
    - outer: VSG 33.1
    - middle: Satinato
    - inner: insulating glass with low-E coating
  - AP 3021 kickplate
  - Surface finish: RAL 7016



- AP08**
- AP 80.825 door pull handle made of high-grade steel
  - Glass pane:
    - outer: VSG 33.1
    - middle: sandblasted with transparent frame
    - inner: insulating glass with low-E coating
  - AP 3021 kickplate
  - Surface finish: RAL 9016



#### AP13

- AP 200.1600 door pull handle made of high-grade steel/Jatobe wood
- Flush Alunox inlay; on the outside face
- Glass pane:
  - outer: VSG 33.1
  - middle: Satinato
  - inner: insulating glass with low-E coating
- Surface finish: RAL 7016



#### AP09

with a sidelite

- AP 60.1400 door pull handle made of high-grade steel
- Flush Alunox inlay; on the outside face
- Glass pane:
  - outer: VSG 33.1
  - middle: sandblasted glass with transparent frame
  - inner: insulating glass with low-E coating
- Surface finish: RAL 7016/ sweet cherry - ADEC C112



#### AP12

- AP 50.1200 door pull handle made of high-grade steel
- Glass pane:
  - outer: VSG 33.1
  - middle: sandblasted glass with transparent frame
  - inner: insulating glass with low-E coating
- Surface finish: RAL 9007/RAL 3004

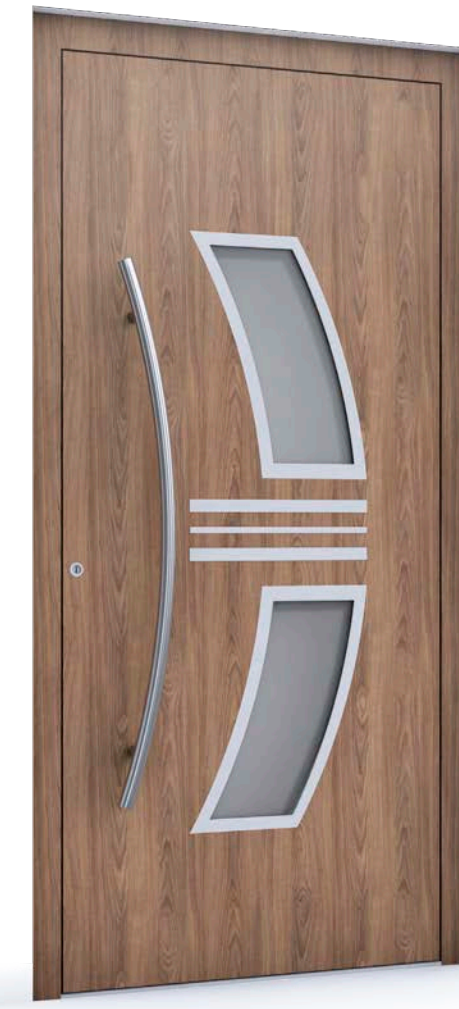

#### AP15

- AP 50.1200 door pull handle made of high-grade steel
- Flush Alunox inlay; on the outside face
- Glass pane:
  - outer: VSG 33.1
  - middle: Satinato
  - inner: insulating glass with low-E coating
- Surface finish: wallnut - ADEC 0102

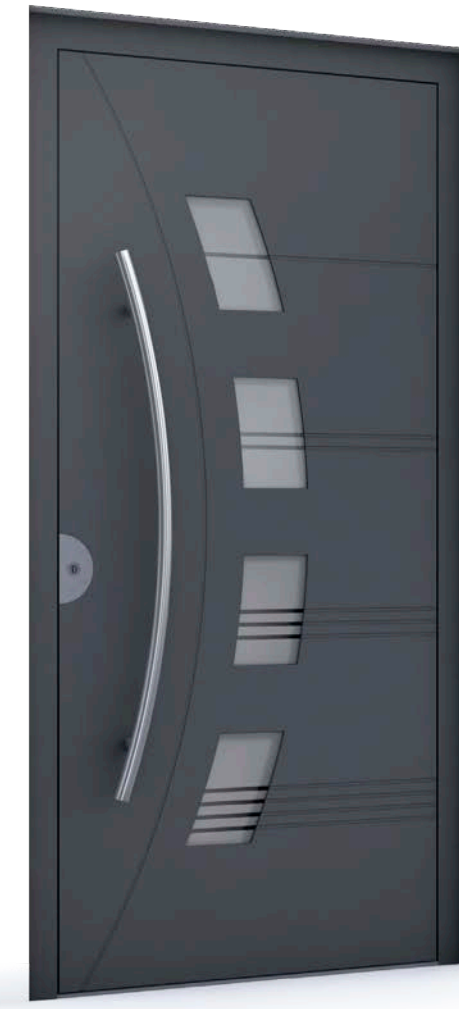

#### AP17

- AP 50.1200 door pull handle made of high-grade steel
- Carves; on the outside face
- Glass pane:
  - outer: VSG 33.1
  - middle: sandblasted with transparent strips
  - inner: insulating glass with low-E coating
- AP 3300 anti-scratch protection
- Surface finish: DB 703





#### AP05

- AP 40.1600 door pull handle made of high-grade steel
- Carves; on the outside face
- AP 3021 kickplate
- Surface finish: RAL 9005



#### AP04

- AP 60.1600 door pull handle made of high-grade steel
- Flush Alunox inlay; on the outside face
- AP 3021 kickplate
- Surface finish: Winchester - ADEC D207



#### AP10

- AP 60.1800 door pull handle made of high-grade steel
- AP 3400 anti-scratch protection
- AP 3020 kickplate
- Surface finish: RAL 9006



#### AP20

- AP 60.1600 door pull handle made of high-grade steel
- Glass pane:  
outer: VSG 33.1  
middle: sandblasted chosen motif  
inner: insulating glass with low-E coating
- AP 3400 anti-scratch protection
- Decorative elements: ornamental frame on the outside
- Surface finish: Vien walnut - ADEC O102



The actual product colours may vary from the colours shown

# Pull handle



## AP 40

pull handle, dia. 30 mm  
(right-angle holders),  
stainless steel,  
matte, polished

- AP 40.600 30x600 mm
- AP 40.800 30x800 mm
- AP 40.1000 30x1000 mm
- AP 40.1200 30x1200 mm
- AP 40.1400 30x1400 mm
- AP 40.1600 30x1600 mm
- AP 40.1800 30x1800 mm



## AP 60

pull handle, 40 x 10 mm  
(right-angle holders),  
stainless steel,  
matte, polished

- AP 60.600 40x10x600 mm
- AP 60.800 40x10x800 mm
- AP 60.1000 40x10x1000 mm
- AP 60.1200 40x10x1200 mm
- AP 60.1400 40x10x1400 mm
- AP 60.1600 40x10x1600 mm
- AP 60.1800 40x10x1800 mm



## AP 100

pull handle, 30 x 30 mm  
(right-angle holders),  
stainless steel,  
matte, polished

- AP 100.600 600 mm
- AP 100.800 800 mm
- AP 100.1000 1000 mm
- AP 100.1200 1200 mm
- AP 100.1400 1400 mm
- AP 100.1600 1600 mm
- AP 100.1800 1800 mm



## AP 80

pull handle, 40 x 10 mm  
(right-angle holders),  
stainless steel,  
matte, polished or black finished

- AP 80.625 625 mm
- AP 80.825 825 mm
- AP 80.1025 1025 mm
- AP 80.1225 1225 mm
- AP 80.1425 1425 mm
- AP 80.1625 1625 mm
- AP 80.1825 1825 mm

Available colours:



stainless steel



black



## AP 50

pull handle, dia. 30 mm  
(holders bent to the side),  
stainless steel,  
matte, polished

- AP 50.600 30x600 mm
- AP 50.1000 30x1000 mm
- AP 50.1200 30x1200 mm



## AP 200

pull handle, dia. 35 - 40 mm  
(right-angle holders),  
Jatobe/stainless steel,  
matte, polished

- AP 200.800 800 mm
- AP 200.1200 1200 mm
- AP 200.1600 1600 mm



## AP 130

pull handle, 30 x 20 mm  
(right-angle holders),  
stainless steel,  
matte, polished

- AP 130.630 630 mm
- AP 130.830 830 mm
- AP 130.1030 1030 mm
- AP 130.1230 1230 mm
- AP 130.1430 1430 mm
- AP 130.1630 1630 mm



## AP 30

pull handle, dia. 30 mm  
(holders turned 45 deg.),  
stainless steel,  
matte, polished

- AP 30.600 30x600 mm
- AP 30.800 30x800 mm
- AP 30.1000 30x1000 mm
- AP 30.1200 30x1200 mm
- AP 30.1400 30x1400 mm
- AP 30.1600 30x1600 mm
- AP 30.1800 30x1800 mm



## AP 70

pull handle, 40 x 10 mm  
(holders turned 45 deg.),  
stainless steel,  
matte, polished

- AP 70.600 40x10x600 mm
- AP 70.800 40x10x800 mm
- AP 70.1000 40x10x1000 mm
- AP 70.1200 40x10x1200 mm
- AP 70.1400 40x10x1400 mm
- AP 70.1600 40x10x1600 mm
- AP 70.1800 40x10x1800 mm



## AP 110

pull handle, 30 x 30 mm  
(holders turned 45 deg.),  
stainless steel,  
matte, polished

- AP 110.600 600 mm
- AP 110.800 800 mm
- AP 110.1000 1000 mm
- AP 110.1200 1200 mm
- AP 110.1400 1400 mm
- AP 110.1600 1600 mm
- AP 110.1800 1800 mm



## AP 90

pull handle, 40 x 10 mm  
(holders bent forward),  
stainless steel,  
matte, polished

- AP 90.600 600 mm



## AP 46

pull handle, 40 x 25 mm,  
semi-circular (right-angle  
holders), stainless steel,  
matte, polished or black finished

- AP 46.625 625 mm
- AP 46.825 825 mm
- AP 46.1025 1025 mm
- AP 46.1225 1225 mm
- AP 46.1425 1425 mm
- AP 46.1625 1625 mm
- AP 46.1825 1825 mm

Available colours:



stainless steel



black



## AP 210

pull handle, dia. 35 - 40 mm  
(holders turned 45 deg.),  
Jatobe/stainless steel,  
matte, polished

- AP 210.800 800 mm
- AP 210.1200 1200 mm
- AP 210.1600 1600 mm



## AP 270

Horizontal pull handle

- AP 270 60x550mm



## AP 250

Horizontal pull handle

- AP 250 480x65mm

# Lever handles



lever handle: 1924216X  
stainless steel, natural  
anode and inox, white,  
anthracite, black

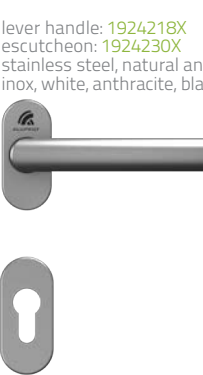

lever handle: 1924218X  
escutcheon: 1924230X  
stainless steel, natural anode and  
inox, white, anthracite, black

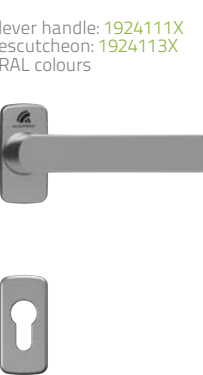

lever handle: 1924111X  
escutcheon: 1924113X  
RAL colours



lever handle: 8001289X  
escutcheon: 1924113X  
RAL colours, natural  
anode, faux anode

Aluprof offers a wide range of kickplates and door protection plates as anti-scratch protection of the door surface.

## AP 3300

Flush anti-scratch protection,  
Alunox

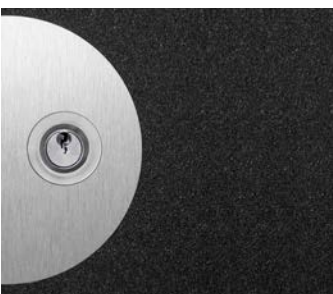

## AP 3400

Flush anti-scratch protection,  
Alunox



## AP 3500

Flush anti-scratch protection,  
Alunox



## AP 3000

Flush kickplate – Alunox



130 mm high

## AP 3020

Flush kickplate – Alunox

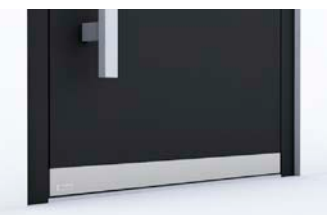

60 mm high

## AP 3021

Flush kickplate – Alunox



30 mm high



# Wood-like coatings and RAL colours



## //RAL & structural colours\*



\*All RAL colours and structural colours as per the offer The colours may vary slightly from the finished product

## //Ornaments and glazing

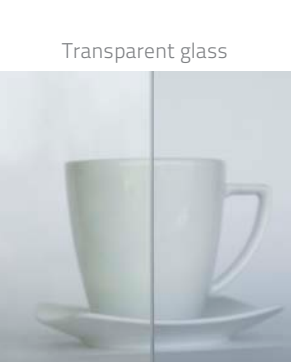
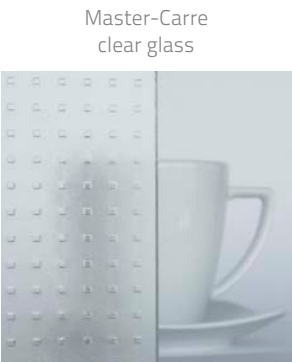
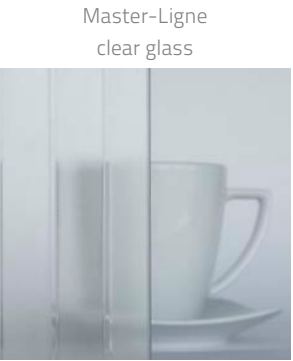
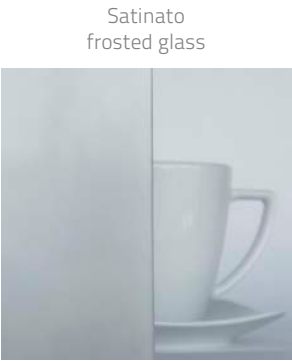
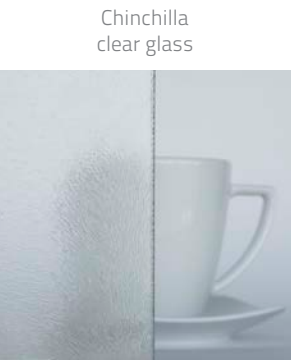

VitrineAlu offers a wide range of glass with motif, glass made of transparent or ornamental glass in its most popular models

All door models come in variants with sidelight and toplight.

- Version 1:** glass with motif
- Version 2:** transparent glass
- Version 3:** ornamental glass

Sidelights and fixed lights include triple glazing units with warm glass spacers. Sidelights (fixed glazing) can be placed either on one or on both sides of the door assembly. Maximum sidelight width: 1400mm.

**Triple glazing:** Ug- from 0.5 to 0.7W/m²K  
For depth of frame from 44-85 mm  
(black, warm edge spacer bar)

- outer:** 6 mm laminated safety glass (VSG)
- middle I:** sandblasted glass/ leaded stained glass/ insulating glass with low-E coating
- inner:** insulating glass with low-E coating

**Quadruple glazing:** Ug- 0.5 W/m²K  
For 95 mm frame depth  
(black, warm edge spacer bar)

- outer:** 6 mm laminated safety glass (VSG)
- middle I:** sandblasted glass/leaded stained glass /insulating glass with low-E coating
- middle II:** insulating glass with low-E coating
- inner:** insulating glass with low-E coating



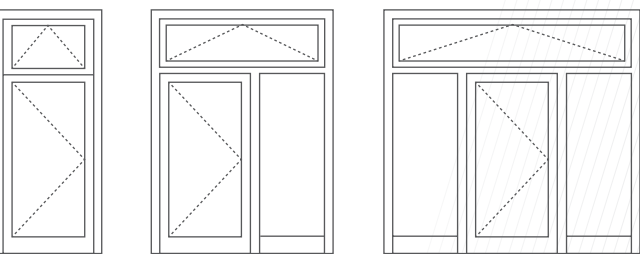

1 2 3

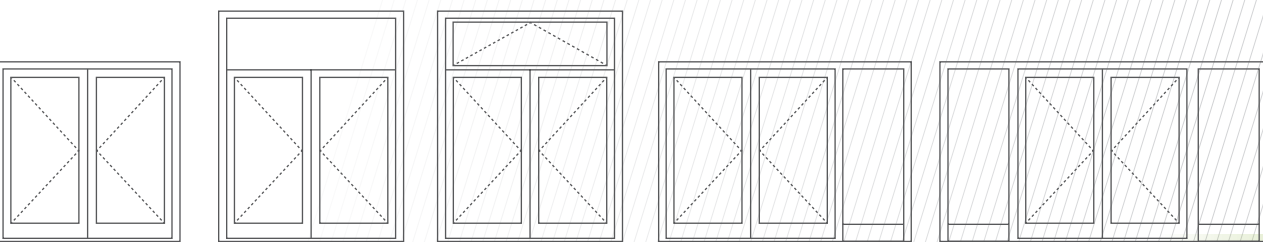

4 5 6 7 8

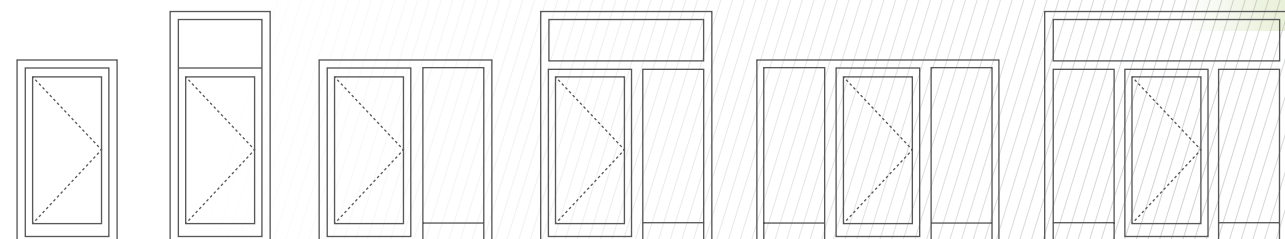

9 10 11 12 13 14

[WWW.VITRINEALU.CO.UK](http://WWW.VITRINEALU.CO.UK)







# VitrineAlu

bring light into living

